

## 2ND FLOOR

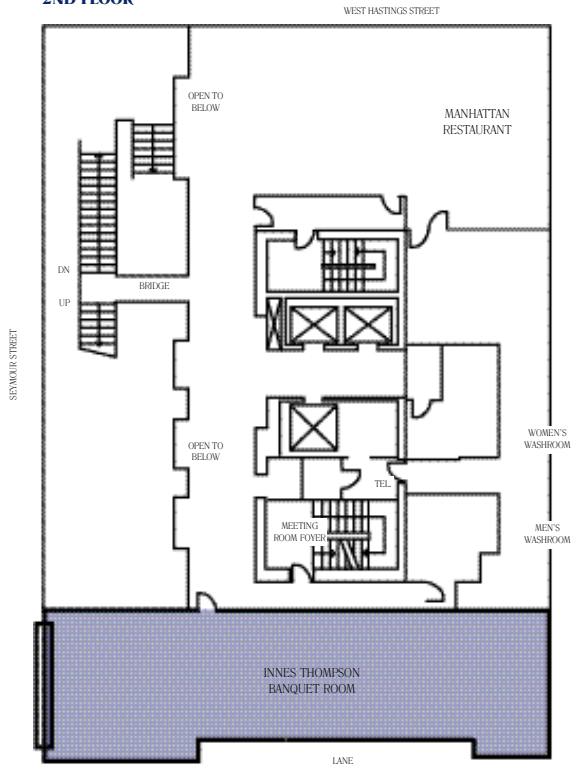

## 3rd FLOOR

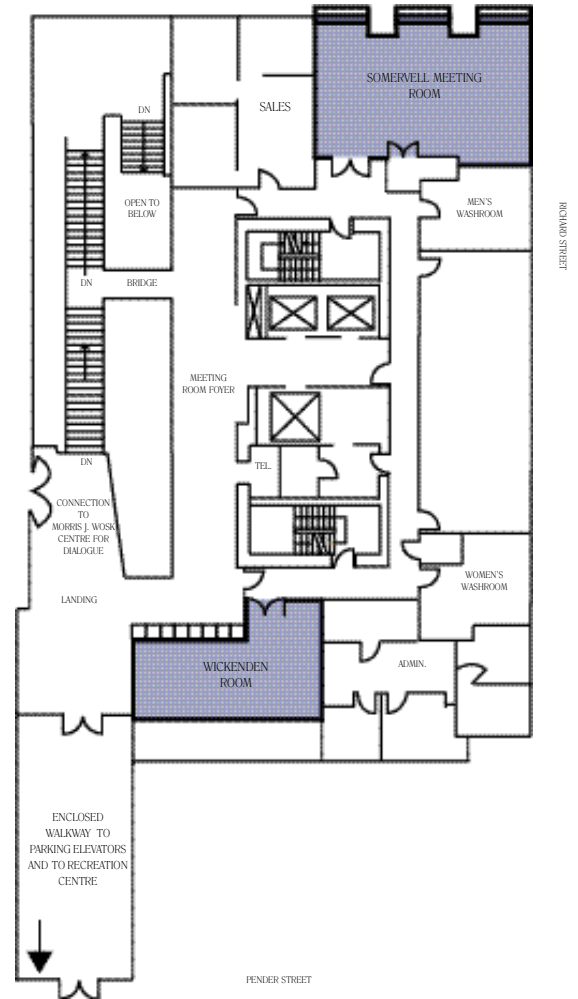

### OTHER MEETING FACILITIES:

SFU AT HARBOUR CENTRE (DIRECTLY ACROSS THE STREET FROM THE HOTEL) WITH OVER 40 MEETING ROOMS (THEATRES, POLICY AND SEMINAR ROOMS) FOR 6 TO 200 PEOPLE.

SFU SEGAL GRADUATE SCHOOL OF BUSINESS, OFFERING ELEGANT EVENT SPACE AND TIERED MEETING ROOMS.