

Delta Edmonton Centre Suite Hotel Specifications

LOCATION	SIZE (FEET)	SQ. FOOTAGE	*ROUNDS W/DANCE (10 PER TABLE)	*HALF ROUNDS (5 PER TABLE)	*RECEPTION	*CLASSROOM (2 PER 6 FOOT TABLE)	*THEATRE	*BOARDROOM	*U-SHAPE	*HOLLOW SQUARE	CEILING HT.
THIRD FLOOR											
MacKenzie	54x34	1,836	-	45	120	40	100	30	40	40	12'
Champlain	54x28	1,512	-	40	100	40	90	30	40	35	12'
Mayfair	23x45	1,035	-	30	75	20	60	20	20	24	12'
Laurier	31x45	1,395	-	35	100	30	70	25	25	35	12'
Mackenzie/Champlain	54x62	3,348	190	95	220	70	190	-	-	-	12'
Mayfair/Laurier	54x45	2,430	130	65	175	40	130	-	-	-	12'
Champlain/Mayfair/Laurier	54x73	3,942	210	105	275	90	220	-	-	-	12'
Centre Ballroom	54x107	5,778	340	170	450	150	400	-	-	-	12'
VIP Club	15x35	525	20	-	40	-	-	18	-	-	10'
FOURTH FLOOR											
Boardroom 404	20x17	340	-	-	20	10	15	10	-	-	10'
FIFTH FLOOR											
Boardroom 504	20x17	340	-	-	20	-	-	10	-	-	10'
SIXTH FLOOR											
Queen Elizabeth West	36x21.5	774	-	25	40	28	50	20	18	20	10'
Queen Elizabeth East	36x21.5	774	-	20	40	20	20	15	12	12	10'
Queen Elizabeth Suite	72x21.5	1,548	-	30	80	30	55	20	-	-	10'
Boardroom 604	20x17	340	-	-	20	-	-	10	-	-	10'
SEVENTH FLOOR											
Victoria East	46x22	1,012	-	20	40	18	30	15	15	15	10'
Victoria West	29x22	638	-	15	30	20	30	12	12	14	10'
Boardroom 704	20x17	340	-	-	20	-	-	10	-	-	10'

Capacities are estimates only. Please contact the sales and catering department and they will match your needs with the appropriate meeting space(s)

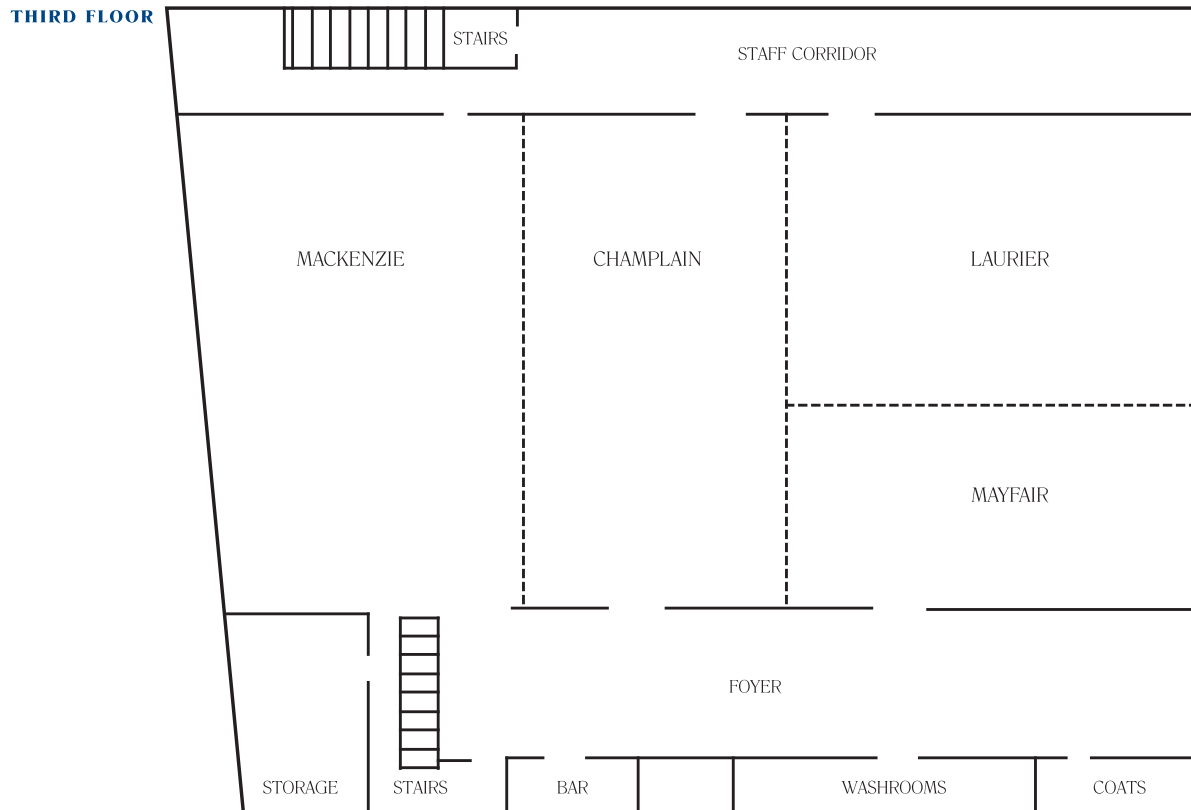

All Third Floor Conference Rooms are equipped with built in projection screens and ceiling mounted projectors.